

LIBERTY ROAD (MD 26)
 MINOR ARTERIAL - RIGHT-OF-WAY VARIES
 ASPHALT PAVED ROADWAY
 55 MPH POSTED SPEED

MATCHLINE THIS SHEET

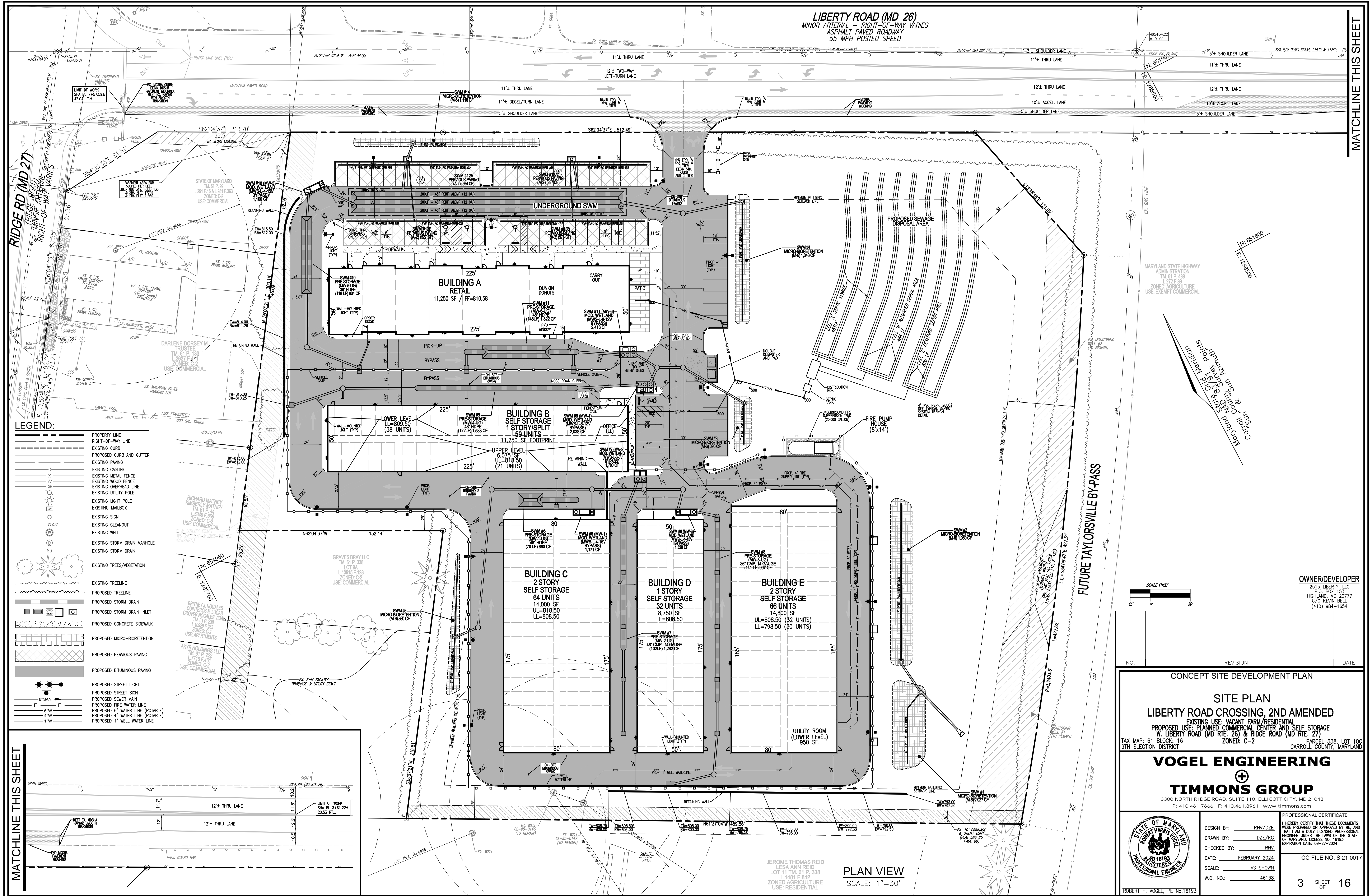

MATCHLINE THIS SHEET

PLAN VIEW
 SCALE: 1"=30'

JEROME THOMAS REID
 LSA ANN REID
 LOT 11 TM, 61 P. 338
 L 1491 F 342
 ZONED AGRICULTURE
 USE: RESIDENTIAL

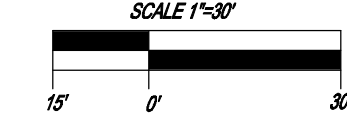

NO.	REVISION	DATE

CONCEPT SITE DEVELOPMENT PLAN

SITE PLAN

LIBERTY ROAD CROSSING, 2ND AMENDED

EXISTING USE: VACANT FARM/RESIDENTIAL
 PROPOSED USE: PLANNED COMMERCIAL CENTER AND SELF STORAGE
 LIBERTY ROAD (MD RTE. 26) & RIDGE ROAD (MD RTE. 27)
 ZONED: C-2

TAX MAP: 61 BLOCK: 16 PARCEL 338, LOT 10C
 9TH ELECTION DISTRICT CARROLL COUNTY, MARYLAND

VOGEL ENGINEERING

TIMMONS GROUP

3300 NORTH RIDGE ROAD, SUITE 110, ELLICOTT CITY, MD 21043
 P: 410.461.7666 F: 410.461.8961 www.timmons.com

PROFESSIONAL CERTIFICATE

I HEREBY CERTIFY THAT THESE DOCUMENTS WERE PREPARED OR APPROVED BY ME, AND THAT I AM A DULY LICENSED PROFESSIONAL ENGINEER UNDER THE LAWS OF THE STATE OF MARYLAND, LICENSE NO. 16193, EXPIRATION DATE: 09-27-2024

DESIGN BY: RHV/DZE CC FILE NO. S-21-0017

DRAWN BY: DZE/KG 3 SHEET OF 16

CHECKED BY: RHV

DATE: FEBRUARY 2024

SCALE: AS SHOWN

W.O. NO.: 46138

ROBERT H. VOGEL, PE No. 16193